

Module-4

- 7 Estimate the bill of quantities of following item of a two roomed building given in Fig.Q7
By long wall short wall method.
- Earth work in excavation in foundation trench
 - Lime concrete in foundation
 - First class brick in 1 : 6 cement mortar in foundation and plinth
 - 2.5 cm thick DPC (1 : 2 : 4) with water proofing compound.

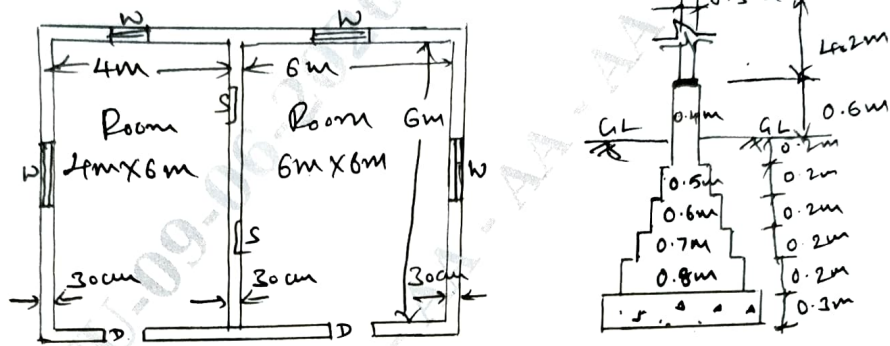

Fig.Q7

The dimensions of doors, windows and shelves are door $D = 1.2 \text{ m} \times 2.10 \text{ m}$, windows $w = 1.00 \text{ m} \times 1.5 \text{ m}$ shelves $S = 1 \text{ m} \times 1.5 \text{ m}$.
(20 Marks)

OR

- 8 Estimate the bill of quantities of the following items of a two roomed building given in Fig.Q7 by centre line method.
- Earth work in excavation in foundation trench
 - Lime concrete in foundation
 - First class brick in 1 : 6 cement mortar in foundation and plinth
 - 2.5 cm thick DPC (1 : 2 : 4) with water proofing compound.
- (20 Marks)

Module-5

- 9 How does the architect contribute to the preparation and maintenance of the measurement book (MB) to ensure accurate documentation of work done, materials used and measurements taken on site?
(20 Marks)

OR

- 10 a. Explain the role of architects in monitoring specifications.
(10 Marks)
- b. Write detailed explanation on BOQ.
(10 Marks)
