



ARCHITECTS: HINOJOSA ARCHITECTS AND INTERIORS
LOCATION: 2400 LONE STAR DR DALLAS, TEXAS, US
LANDSCAPE ARCHITECTS: LINDA TYCHER AND ASSOCIATES
TOTAL BUILTUP AREA: 3900 SQM

The vision of Hinojosa Architects was to redefine the standard animal shelter. This new definition transformed 42,000 SF of office space into an environment that is beneficial to the health and welfare of the animals that are seeking adoption. This also allowed for the creation of an inviting experience for the future adopters seeking to welcome a new member to their family.

SPECIFIC PROGRAM COMPONENTS:

Interior components:

- 12 dog pods, 24 cat condos
- surgical suites with prep areas
- clinic and exam areas
- animal dietary areas
- animal health equipment
- retail area and related support spaces

Exterior components:

- outdoor play areas
- detached dogs runs with canopies
- full perimeter security and landscaping upgrades

LOCATION:

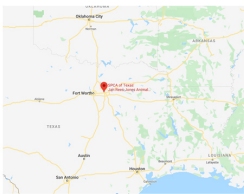

MAP SHOWING WEST DALLAS

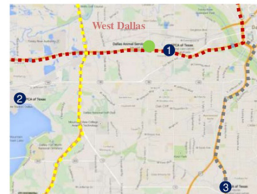

SPCA FACILITIES WITHIN DALLAS

- SPCA animal care center
- Perry clinic
- Spay and neuter center
- Dallas animal services



- Interstate 30
- S Walton Blvd 12
- Interstate 77 Fwy HOV
- Main road
- Bus stop

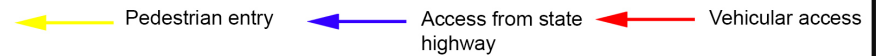
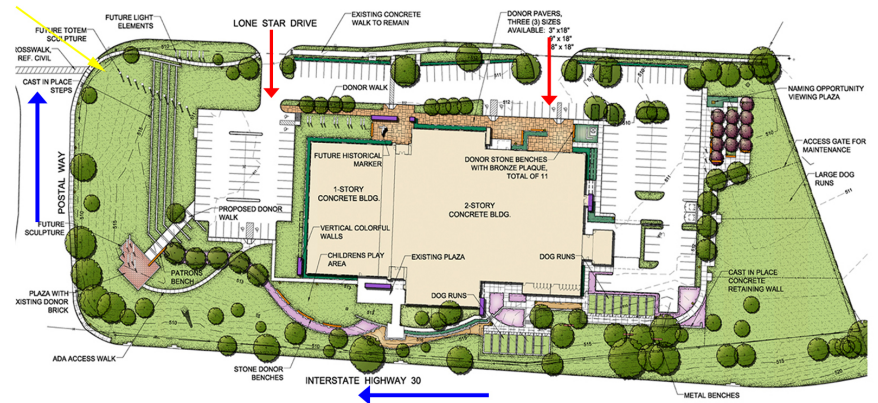

GROUND FLOOR PLAN

SPCA DALLAS

CERTIFICATE

This is to certify that this is a bonafide record of the Architectural Design Project completed by **Ms. VARUNI R** of **X** semester B.Arch **USN NO. 1AA15AT071** on a project titled –

**“ANIMAL WELFARE CENTER, RAJARAJESHWARI
NAGAR, BANGALORE, KARNATAKA.”**

This has been submitted in partial fulfillment of the requirements for the Degree
Of B.Arch awarded by VTU, Belgaum during the year 2019 – 2020

Dean

Acharya's NRV School of Architecture
Bangalore – 560090

Prof. Neha Mahindrakar

(Thesis Guide)

ACKNOWLEDGEMENT

This project would not have been possible without the kind support and help of many individuals and organizations. I would like to extend my sincere thanks to all of them.

Special thanks to Dean, ANRVSA, Prof. Neha Mahindrakar (guide) and all other faculty members for their guidance and support.

Last but not the least, I would like to thank my family and friends for their constant support and understanding during the course of the project.

INTRODUCTION
SUMMARY
DESIGN METHODOLOGY
AIMS AND OBJECTIVES
ANIMAL ASSISTED THERAPY
LITERATURE AND CASE STUDIES:
PALM SPRINGS ANIMAL SHELTER
SPCA, DALLAS
CHARLIE'S ANIMAL CARE CENTER
PRECEDENT STUDY
SITE DETAILS
ZONING
BUBBLE DIAGRAMS
DESIGN CONSIDERATIONS
CONCEPT
AREA STATEMENT
MASTER PLAN
PLANS
ELEVATIONS
SECTIONS
CONCLUSION
BIBLOGRAPHY

C
O
N
T
E
N
T



CENTER FOR
ANIMAL WELFARE

